

Gold Premium Operators Manual



**Call ProMow for ALL Service Needs
Toll Free: 1-877-477-6669**



Dear Valued Customer....

Let me take this opportunity to congratulate you on your purchase of a ProMow Reel Mower System. You have purchased perhaps the most revolutionary new product since the Weedeater! No other product exists that will allow you to mow your yard in 1/3 of the time and give you professionally manicured results all for a fraction of the cost of any alternative.

When used as directed, your ProMow unit will leave your yard looking healthy and lush. After all, the most qualified greenskeepers in the world use ganged reel mowers to manicure their golf courses to "green carpet" perfection!

I recommend that you spend a few minutes and read the mowing tips and the troubleshooting guide found in the following pages. I believe these tips will make your ProMow experience much more satisfying and give you optimum performance with your new ProMow unit.

Also, please take a minute and complete the warranty page found in your packet. You may also complete the registration of your mower online, just link to our web site: <http://warranty.promow.com>. We will need this information should you ever need warranty service and to notify you of changes, upgrades, or possible recall conditions. This information will not be sold or used by anyone other than ProMow, Inc.

Once again, we appreciate your business and hope you experience all the benefits a ProMow mower can bring to you.

Sincerely,

Douglas J. Short
CEO
ProMow, Inc.

Front Wing (Long)

Rear Wing (Short)

Attach wing to frame, tighten bolt secure, snug as possible that allows wing to flex with weight or reel. Oil connection.

Keep wing bolts tight to avoid hole wear and mower tracking true.

(G) Attach to Power Unit.

Tongue top surface should be nearly level when attached to power unit.

(G)

Attach reel to frame as shown (Figure 1) and (Figure 2). Go through top hole of mower and frame tab and pin.

Roller brackets will change height of rear of mower. Use these to

Figure 1

Figure 2



Cutter Bar Adjustment

The cutter bar on your mower was professionally adjusted before it left our shop. Many years of experience tell us that light contact provides a superior cut and the mower can go longer without needing to be sharpened when set this way.

Some customers have reported that their mower was a little difficult to push the first time they used it but that it quickly became easier. Spraying the reel blades with WD40 or another lubricant will reduce the friction between the blades, making the mower easier to push and minimizing wear of the blades.

After considerable use or sharpening, the cutter bar may need adjustment. This requires a 9/16" wrench.

Make certain that the bolts which are threaded into the cutter bar are tight, to eliminate any play or looseness, before beginning adjustment of the cutter bar (fig.6) The short cutter bar bolt (A) must be turned counter clockwise to tighten on the side shown in figure 6. The cutter bar bolt on the opposite side has a regular thread.

To adjust the cutter bar push the handle of the mower forward and let it rest on the ground. The roller will be off the ground (fig.7)

Using a 9/16" wrench, turn the adjustment nut approx. 1/8 turn clockwise to increase the contact between the reel bedknife (fig.6). Turn the adjustment nut counterclockwise 1/8" turn to decrease the contact between the reel and bedknife. Adjust each side equally until there is minimal contact.

It is important that the cutter bar be set so that the contact is even across the cutter bar, from one side of the mower to the other. You can test this by slowly turning the reel and listening to the sound of the reel blades as they contact the cutter bar, or you can use the paper test described on this page (fig 7)

Insert a strip of quality 0.003" paper such as writing paper or a magazine page, approximately 2" wide and 6" long, between the cutter bar and the reel blades (fig.7). Turn the reel slowly and carefully, inserting the paper at intervals across the reel. The reel will turn easily and will cut the paper all the way across the cutter bar.

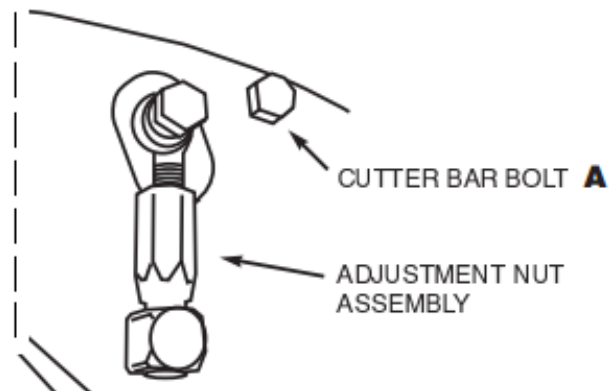

Figure 6

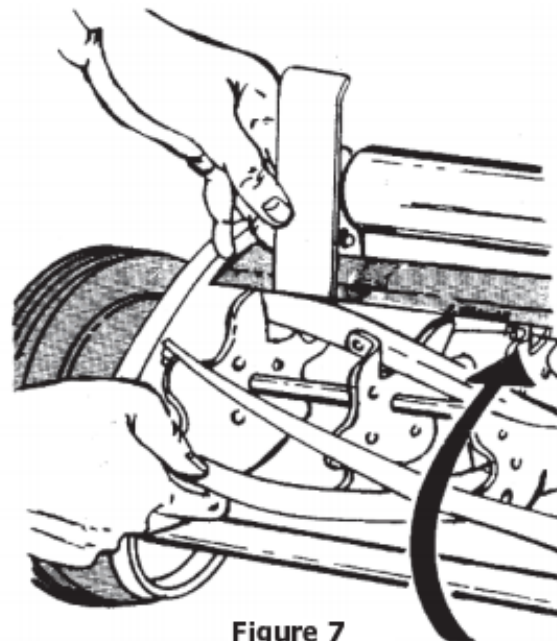

Figure 7



NOTE

Keeping the bed-knife adjusted so that the blades contact slightly, will extend the sharpness of the mower. This is very easy to do and should be done on a regular basis.

Choosing the Cutting Height

Choosing the best cutting height is one of the most important decisions you will make for the health and beauty of your lawn. The best sources of information about lawn care are universities, seed and sod producers, departments of agriculture and the volunteers with the nationwide Master Gardener program. Climate and soil can affect this decision, so the best information comes from a regional source such as the local Master Gardeners. When you locate a credible source of information you will find that they usually give a range of recommended mowing heights, such as "1.5 to 3 inches". Choosing a height at the higher end of that range has many benefits. The blades of grass act as solar collectors; they feed the plant, so taller grass is providing more energy for the lawn and encourages deeper root systems. Deeper roots mean the lawn will be more drought tolerant because during dry spells, it is the surface that dries out fastest, so the deeper soil contains more water.

Taller grass tends to invite fewer weeds. Some

weed seeds must have direct sunlight to sprout, so the shading effect of the taller grass can prevent these weeds from even getting started. Others will simply be crowded out by the tall grass.

Another benefit is the frequency of mowing required. It is best to mow often enough that you are not cutting off more than one third of the length of the blade in any mowing. If you mow to a finished height of 1.5" then you must mow every time the grass grows a half inch. If you mow to a finished height of 3" then you only have to mow every time the grass grows an inch.

Weeds tend to grow faster than grass, so mowing more often will help to prevent those towering weeds that don't get caught between the reel blades and the cutter bar, and therefore do not get cut. Your taller grass will be greener, healthier, need less water, have fewer weeds and will filter out more pollutants and produce more oxygen than a lawn that is mowed too severely. © Marjorie King, 2009

Cutting Height Adjustment

Refer to Height Adjustment sheet included in your manual.

Maintenance

Lubrication

Lubricate the wheels and gears once a season and whenever the reel is sharpened.

Tools required are a standard screwdriver, snap ring pliers, light grease and engine oil, and if rust is present, solvent and crocus cloth.

1. Remove the hub cap using the screwdriver.
2. Remove the e-ring with the screwdriver.
3. Lift off the wheel.
4. Clean rust, if any, from axle, using solvent and crocus cloth.
5. Coat the axle with light grease.
6. Remove the snap ring on the pinion gear, being careful not to loose the ratchet pawl under the pinion gear. It is important to use snap ring pliers in order to prevent damaging the snap ring.
7. Remove the pawl from the reel shaft, noting the exact position it is in. It must be reinstalled in the same position in order to drive the wheel.
8. Apply light grease to the gear teeth on the inside of the wheel Figure 12.
9. Using engine oil, lightly lubricate points indicated in Figures 10 & 11 on roller and between end plates and wheel dust covers. Periodic lubrication on these points will ensure smooth mechanical operation.

Figure 10

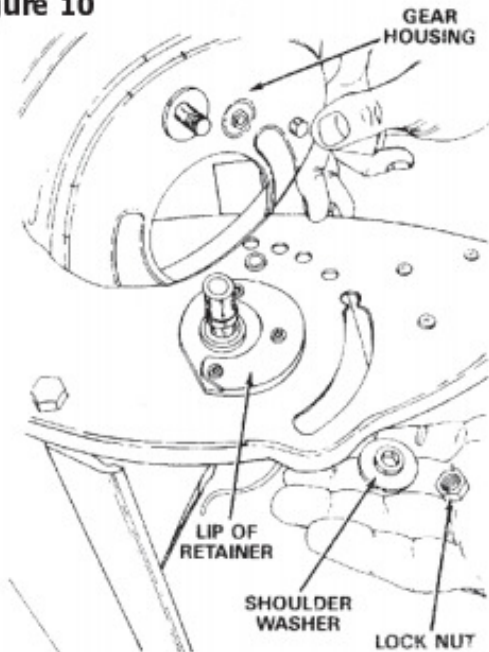

Sharpen Blades

Your Silent Cut reel mower features high quality heat-treated reel and bedknife blades that were professionally sharpened before leaving our shop. Signs that the mower needs to be sharpened include:

The mower will start to become more difficult to push.

When properly sharpened and adjusted, the mower will cut the grass with a clean cut straight across the blade. Dull blades will leave a somewhat ragged cut.

Small dings or light rust on the blades can be removed with sharpening

Always backlap the blades, never use a file.

Gear Housing Assembly

The gear housing must be properly assembled in order to prevent loose wheels, which will result in early failure of the pinion gears and wheels. When replacing the gear housing after it is removed for service, be sure that it fits UNDER the lip of the retainer. The shoulder on the shoulder washer must fit into the slot on the end plate. Tighten the lock nut.

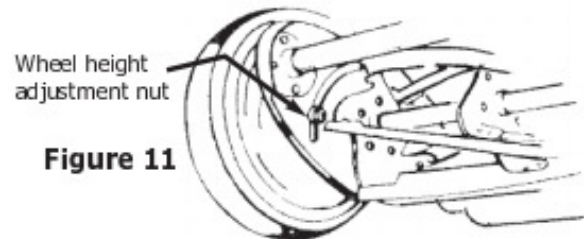

Figure 11

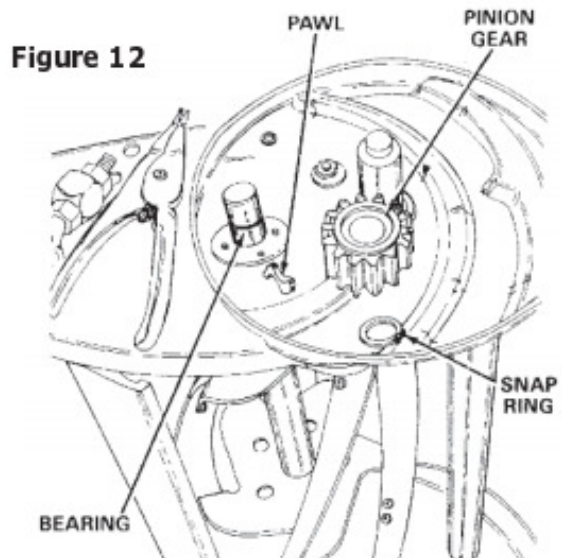

Figure 12

MAINTENANCE AND WARRANTY INFORMATION

Loss of parts due to loose bolts is not covered by warranty.

Check all bolts for tightness regularly; especially the axle and roller bracket bolts

Wing bolts need to be kept tight to prevent hole wear. Wings need to be able to flex with the terrain.

Lubricate reels regularly with light oil such as WD-40.

For all your service needs calls toll-free 1-877-477-6669.

Refer to owner's manual for more information on warranty and maintenance.

PROMOW MOWING TIPS

- **THIS IS A FINISH CUT MOWER ONLY.** IT IS NOT INTENDED TO CUT WEEDS OR VERY TALL GRASS.
- FOR BEST RESULTS WHEN MOWING, DO NOT CUT OFF MORE THAN 1"-2" OF GRASS DURING EACH MOWING.
- IF YOU ALLOW YOUR GRASS TO GROW TO A TALLER LENGTH, MOWING TWICE WILL RESULT IN THE SMOOTHEST CUT.
- EACH TIME YOU MOW, MOW AT A DIFFERENT ANGLE. CROSS MOWING WILL RESULT IN THE SMOOTHEST CUT.
- CHECK CUTTER BARS EVERY 2-3 MOWINGS. TO KNOW THE BARS ARE ADJUSTED, REELS WILL JUST TOUCH THE CUTTER BAR MAKING A LIGHT WHISPING NOISE AND SHOULD CUT PAPER ACROSS THE ENTIRE CUTTER BAR. TO ADJUST CUTTER BARS REFER TO "MAINTENANCE AND ADJUSTMENT" PAGE.
- IF YOU NOTICE WHEEL MARKS FROM TRACTOR, YOU ARE WAITING TOO LONG BETWEEN MOWINGS OR YOUR GRASS MAY BE TOO WET.
- TO HELP ON RUST & WEAR, SPRAY W-D 40, OR SIMILAR LUBRICANT ON THE CUTTER BAR AFTER EACH MOWING.
- ALWAYS STORE IN A DRY PLACE.
- AFTER CONSIDERABLE USE YOUR PROMOW UNIT MAY NEED TO BE SHARPENED. THIS CAN BE DONE AT HOME WITH A PROMOW SHARPENING KIT OR THROUGH YOUR LOCAL SHARPENING SHOP.

CUSTOMER RESPONSIBILITIES

- READ AND FAMILIARIZE YOURSELF WITH ALL INSTRUCTIONS AND USEAGE HINTS IN THIS MANUAL.
- INSPECT YOUR MOWING AREA FOR ANY DEBRIS OR OBJECTS THAT COULD CAUSE PROBLEMS AND REMOVE PRIOR TO MOWING.
- MAKE SURE YOUR MOWER IS IN SAFE OPERATING CONDITION. DO NOT ATTEMPT TO OPERATE IF YOU HAVE ANY DAMAGE' REPAIR IT FIRST.
- **TRAVEL AT A SAFE SPEED. EXCESSIVE SPEED IS UNSAFE AND MAY CAUSE DAMAGE TO THE UNIT.
- DO NOT MOW NEAR SMALL CHILDREN OR OTHER PEOPLE.
- PERIODICALLY CHECK YOUR UNIT FOR DAMAGE AND MAKE SURE ALL NUTS AND BOLTS ARE TIGHT.
- ALWAYS EXERCISE CARE WHEN OPERATING YOUR MOWER, AVOID STRIKING OR RUNNING INTO OR OVER SOLID OBJECTS OR DEBRIS.

CARE

- KEEP YOUR MOWER CLEAN AND REGULARLY LUBRICATE BLADES WITH WD-40 OR SIMILAR LUBRICANT. RECOMMENDED AFTER EACH MOWING.
- CHECK ALL BOLTS AND NUTS TO BE SURE THEY ARE PROPERLY SECURED.
- STORE IN A CLEAN DRY AREA.
- DO NOT TRAVEL WITH THE WINGS IN UPRIGHT POSITION. DAMAGE TO THE FRAME OR MOWER HEADS CAN RESULT.
- IF YOU HAVE ANY QUESTIONS OR PROBLEMS CALL PROMOW TOLL FREE: 1-877-477-6669.

WARRANTY

SEE "WARRANTY REGISTRATION - NEW EQUIPMENT LIMITED WARRANTY" IN THIS MANUAL. WARRANTY WILL NOT BE EFFECTIVE UNLESS REGISTERED BY COMPLETING FORM AND MAILING TO PROMOW.

****CAUTION: A brisk walk, about 4 MPH, should be considered top speed. Reduce speed down from 4 MPH on rough terrain. Speeds that exceed 4 MPH on smooth turf will cause premature wearing of the bearings and possible damage to the reel itself.**

EVIDENCE OF EXCESSIVE SPEED WILL VOID WARRANTY

Problem or Questions? Call ProMow Toll-Free: 1-877-477-6669

WARRANTY REGISTRATION

NEW EQUIPMENT LIMITED WARRANTY

LIMITED WARRANTY

ProMow, Inc. product warranties and obligations set forth below are in lieu of any other express warranties or obligations of ProMow, Inc., its distributors, or retailers. The warranties and limitations extend only to the original purchaser or to the person for whom the product was originally purchased for.

For one year from purchase on mower heads and two years on frames (warranty card must be on record to enforce warranty) ProMow, Inc. will replace free of charge to the original buyer, any part(s) found defective in material or workmanship upon examination by our factory or a factory authorized service center. Damage due to misuse, abuse, or modification is excluded...as in normal wear such as tire wear, dulling of blades, lost parts, etc. Parts sent to factory for replacement must be shipped pre-paid by the buyer. **Contact ProMow, Inc. for all warranty claims and adjustments prior to shipping.** ProMow reserves the right to make changes in materials or design of the product at any time without notice. No other warranty of any kind whatsoever, express or implied, is made with respect to this sale; and all implied warranties of merchantability and fitness for a particular purpose which exceed the obligations set forth in this written warranty are hereby disclaimed and excluded from this sale.

Date of Purchase: _____

Model: _____

Serial No: _____

Name: _____

Street: _____

City: _____

State: _____ Zip: _____

Daytime Phone: _____

E-Mail: _____

(This data for ProMow Use Only)

Web: www.promow.com

LIMITATION OF REMEDY

During the warranty period, ProMow will at its option either repair or replace defective mower heads or frames. **To obtain repair or replacement, call ProMow, Inc customer service for a return authorization number.** Then attach your name, address, phone number, description of problem and proof of purchase (for example, a sales receipt or cancelled check) to the product. At your expense, ship or deliver the product to ProMow, Inc. located at 8318 Clinton Park Drive, Ft. Wayne, Indiana 46825.

Some states do not allow limitations on how long warranty lasts, and some states do not allow the exclusion of limitations of incidental or consequential damages, so the above limitations or exclusions may not apply to you.

RELEASE OF LIABILITY

I agree that I will release ProMow, Inc, its distributors and retailers from any and all responsibility or liability for injuries or damages to the user of the ProMow gang-reel mowers I am purchasing, or to any other person. I agree not to make a claim against ProMow, Inc., its distributors or retailers for injuries or damages relating to use of the equipment, other than such claims are allowed by the limited warranty set forth above.

Dealer Name: _____

Address: _____

City: _____

State: _____ Zip: _____

WARRANTY WILL NOT BE EFFECTIVE UNLESS REGISTERED BY COMPLETING THIS FORM AND MAILING WITHIN 15 DAYS OF PURCHASE.

MAIL TO:

ProMow, Inc. 8318 Clinton Park Drive
Ft. Wayne, IN 46825 (260) 482-6699